

**WARNING Protect personnel against electrical shocks**

The luminaire connections shall be performed by qualified personnel in conformance with local and national electrical codes. Ensure that the AC service is OFF before installation or maintenance. Do not switch AC service to ON until the entire installation is complete.



TX03



VX022

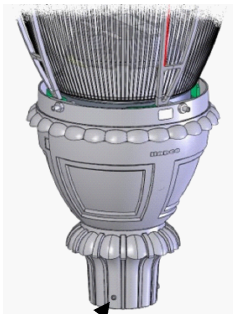

3x

**Tools Required:**

- 5/32" Allen wrench/driver (set screws) or 1/2" socket/driver (hex bolts)
- Torque wrench capable of 7 – 11 ft.lbs. torque
- Slotted screw driver (B & T pods only)

**1) Prepare for Installation**

- Loosen pole fasteners, if required
- Out Wires: If supply wires are strain-relieved in pole, make connections to supplied out wires.  
**Note:** If fixture includes dimming an orange override wire will be present
- Terminal Block (B or T pod only):

Open tool-less door.

Pull 12 to 18 inches of wire beyond top of pole.

Install supply wires into terminal block.

**2) Install on Pole**

- Ensure that wires are not pinched.
- Slip luminaire onto pole
- Torque pole fasteners as follows:

Set screws - 7 ft. lbs.

Hex bolts - 11 ft. lbs.

**CAUTION Prevent over torque damage**

Do not over torque nuts and bolts.

- Strain relieve supply wires using wire tie in pod if needed.

**Install Photo Cell** (if applicable)

**Re-install Pod Door** (if applicable)

- Ensure that wires are not pinched

**5) Restore AC power**