

# Low Level Decorative Luminaire

120VAC, 120VAC dimmable and 12V AC/DC models

## INSTALLATION AND OPERATING INSTRUCTIONS

### IMPORTANT SAFEGUARDS

When using electrical equipment, basic safety precautions should always be followed, including the following:

### READ AND FOLLOW ALL SAFETY INSTRUCTIONS

All servicing should be performed by qualified personnel only.

Equipment should be mounted in locations and at heights where it will not be readily subjected to tampering by unauthorized personnel.

The use of accessory equipment not recommended by the manufacturer may cause an unsafe condition.

Do not use this equipment for other than intended use.

Do not let supply cords touch hot surfaces.

Do not mount near gas or electric heaters.

**CAUTION:** To avoid electrical overload, total connected lamp load (factory and field installed) should not exceed output rating.

### SAVE THESE INSTRUCTIONS

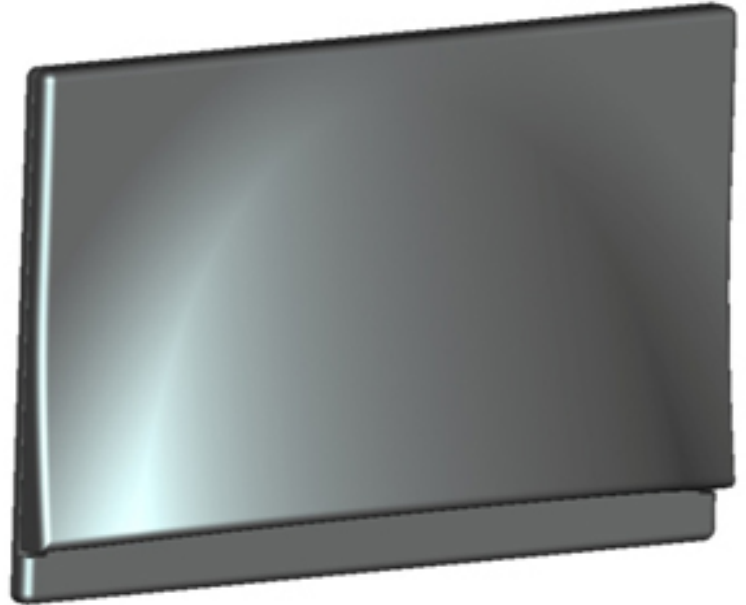

**WARNING** – Shut off AC power to branch circuits to which units will be connected. All wiring should be per N.E.C. Articles 501-4(b) and local codes.

**This product is designed for installation into new construction or retrofit applications. For new construction, no preparation is required other than making sure a single gang junction box or 4S/5S junction box with metal mudplate is installed and power is supplied. For retrofit applications, removal of the electrical outlet, switch or existing equipment must be done first by a certified electrician.**

**The luminaire is delivered preassembled and ready to install.**

**CHLORIDE**

Signify North America Corporation  
200 Franklin Square Drive  
Somerset, NJ 08873, USA  
Phone: 855-486-2216  
[www.chloride-lighting.com](http://www.chloride-lighting.com)

Signify Canada Ltd./Signify Canada Ltée.  
281 Hillmount Road,  
Markham, ON, Canada L6C 2S3  
Phone: 800-668-9008

July 2018  
43580498071

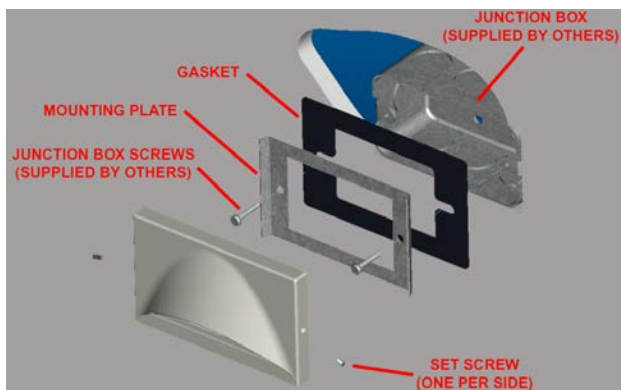

SWITCH SETTINGS FOR 12-24VAC/DC INPUT		
	1	2
LOW	OFF	OFF
MEDIUM	ON	OFF
HIGH	ON	ON

**Line Voltage (120VAC Input – Dimmable and non-dimmable models)** Installation procedure is as follows:

1. Disconnect or switch off power coming into the junction box.
2. Attach steel mounting plate and gasket (if desired) to the junction box.
3. Connect line voltage (120VAC) to the flying leads of the power supply module. Use UL certified or listed wire nuts to connect (120V) to black wire and (COM) to white wire. Connect green ground wire from building ground to green ground wire on luminaire.
4. Attach complete luminaire to the steel mounting plate using the set screws supplied. The set screws thread into the product and catch behind the upturned edges of the steel mounting plate.
5. Reconnect power or switch on power coming into the junction box.

**Troubleshooting:**

**Light does not turn on:**

Ensure that power to the junction box is not turned off. If connected to a switch, turn on power at the switch. A delay time of up to one second may be experienced when turning on the light. If the product still does not light, contact your supplier for technical assistance.

**Light takes one second to turn on:**

This is normal behavior for the LED driver.

**Low Voltage (12-24VAC/DC Input)**

Installation procedure is as follows:

1. Disconnect or switch off power coming into the junction box.
2. Attach steel mounting plate and gasket (if desired) to the junction box.
3. Connect low voltage Class 2 UL Recognized and approved power sources (see company website for Class 2 power sources) to the red and black leads of the luminaire. Do not install the luminaire with other than intended Class 2 power supplies. Connection to the leads is polarity independent.
4. Set the brightness level by setting dip switches to LO, MED or HI (see label on back of luminaire)
5. Attach complete luminaire to the steel mounting plate using the set screws supplied. The set screws thread into the product and catch behind the upturned edges of the steel mounting plate.
6. Reconnect power or switch on power coming into the junction box.

**Troubleshooting:**

**Light does not turn on:**

Ensure that power to the junction box is not turned off. If connected to a switch, turn on power at the switch. A delay time of up to one second may be experienced when turning on the light. If the product still does not light, contact your supplier for technical assistance.

**Light takes one second to turn on:**

This is normal behavior for the LED driver.

**Cannot dim the fixture with external wall dimmer:**

This product is designed to put out a constant brightness despite fluctuations in the input voltage/power. Therefore, it is not intended to be used with a dimmer. It is recommended that if a lower brightness setting is required, that the dip switches be set accordingly.