

Gardco **Form Ten LED round arm mount luminaires** are cutoff area luminaires featuring LED arrays. These products provide excellent performance and feature advanced Gardco LED thermal management technology. High performance Class 1 LED systems offer the potential for energy savings up to 50% when compared to HID systems.

Retrofit Kits are an easy way to supply your existing luminaires with high performance LED arrays. These kits permit a simple and efficient changeout, saving time, cost and energy.

The kits include everything required to completely convert the standard Form Ten Round to any of the offered LED wattages and distributions. This includes a new reflector pan outfitted with LED arrays and integral driver(s).

Project: _____
 Location: _____
 Cat.No: _____
 Type: _____
 Lumens: _____ Qty: _____
 Notes: _____

Retrofit kit ordering guide

Example: CA/MA17L-RK-32L-450-NW-G3-4-UNV

Prefix	Number of LEDs	Drive Current	LED Color - Generation	Distr.	Voltage	Controls	Electrical
CA/MA17L-RK or CP/MP17L-RK 17" Cylindrical or Semi-Spherical Retrofit Kit	32L 32 LEDs	450 450mA 900 900mA	NW-G3 Neutral White 4000K, 70CRI Generation 3 WW-G3 Warm White 3000K, 70CRI Generation 3 CW-G3 Cool White 5700K, 70CRI Generation 3	2 Type 2 3 Type 3 4 Type 4 5 Type 5	120 120V 208 208V 240 240V 277 277V 347 347V 480 480V UNV 120-277V 50hz/60hz HVU 347-480V 50hz/60hz	DD 0-10V Dimming Driver	Surge Protection Blank Standard 10kV/10kA SP2 20kV/10kA (option)
CA/MA22L-RK or CP/MP22L-RK 22" Cylindrical or Semi-Spherical Retrofit Kit	48L 48 LEDs 96L 96 LEDs	900 900mA 560 560mA					

Dimensions and EPA

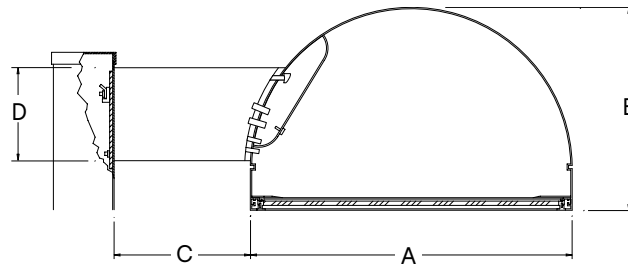

MA style

Size	A	B	C	D	EPA's Single	EPA's Twin	EPA's Quad	Weight Single
MA17	17" 43.18cm	11" 27.94cm	5" 12.70cm	5" 12.70cm	.8ft ² .07m ²	1.6ft ² .15m ²	2.3ft ² .21m ²	27lbs. 12.25kg
MA22	22" 55.88cm	14" 35.56cm	7" 17.78cm	5" 12.70cm	1.3ft ² .12m ²	2.7ft ² .25m ²	3.7ft ² .34m ²	40lbs. 18.14kg

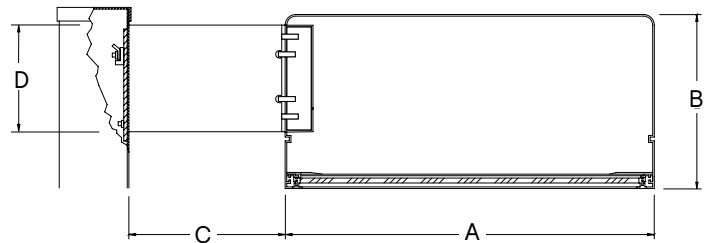

CA style

Size	A	B	C	D	EPA's Single	EPA's Twin	EPA's Quad	Weight Single
CA17	17" 43.18cm	8" 20.32cm	5" 12.70cm	5" 12.70cm	.7ft ² .07m ²	1.5ft ² .14m ²	2.1ft ² .20m ²	27lbs. 12.25kg
CA22	22" 55.88cm	11" 27.94cm	7" 17.78cm	5" 12.70cm	1.2ft ² .11m ²	2.3ft ² .21m ²	3.3ft ² .31m ²	42lbs. 19.05kg

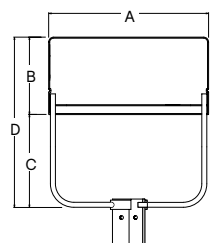

CP style

Size	A	B	C	D	EPA Single	Weight Single
CP17	17" 43.2cm	8" 20.3cm	10" 25.4cm	18" 45.3cm	.7ft ² .07m ²	31lbs. 14.06kg
CP22	22" 55.9cm	11" 27.9cm	11" 27.9cm	22" 55.9cm	1.0ft ² .09m ²	50lbs. 22.68kg

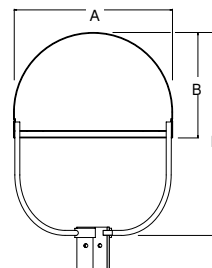

MP style

Size	A	B	C	D	EPA Single	Weight Single
MP17	17" 43.2cm	11" 27.9cm	10" 25.4cm	21" 53.3cm	.7ft ² .07m ²	31lbs. 14.06kg
MP22	22" 55.9cm	14" 35.6cm	11" 27.9cm	25" 63.5cm	1.0ft ² .09m ²	50lbs. 22.68kg

Form Ten Retrofit Kit

Specifications

General Description

Gardco LED retrofit kits provide excellent performance and advanced thermal management technology. These features combine with the distinct styles of Gardco luminaire families to provide outdoor area lighting and pedestrian scale lighting that is both energy efficient and aesthetically pleasing. High performance Class 1 LED systems offer the potential for energy savings up to 50 % when compared to HID systems. When utilized in a Gardco luminaire featuring a flat glass lens, the luminaires provide full cutoff performance.

Thermal Management

Gardco LED retrofit kits provide extruded aluminum integral thermal radiation fins to provide the excellent thermal management so critical to long LED system life.

LED Driver Assembly

LED retrofit kits include lensed LED arrays set to achieve IES Type II, Type III, Type IV and Type V distributions. Individual LED arrays are replaceable. Optical systems are field rotatable. Luminaires feature high performance Class 1 LED systems. Arrays are provided attached to the appropriate optic assembly based on the existing luminaire specified.

Labels

When the LED retrofit is completed using the appropriate components supplied by Gardco, then Gardco luminaires retain UL or CUL (where applicable) wet Location labels. A label shall be included as part of the retrofit kit for affixing to the luminaire and shall indicate the following: "Only replace with Gardco lighting round Form 10 17" or 22".

Warranty

Gardco LED retrofit kits feature a 5 year limited warranty, including a 5 year limited warranty covering the LED arrays and LED drivers. See Warranty Information on signify.com/warranties for complete details and exclusions.