



The new **Gardco Form Ten** family of luminaires offers you a choice of optical systems to suit the needs of all your site lighting applications. Gardco designers were careful to maintain the retro-aesthetic that customers have responded to while providing a modern, updated version for today's requirements.

The ComfortEdge™ technology option achieves excellent photometric control and distribution performance, while creating a comfortable, reassuring environment that enhances outdoor spaces. Precision optic options are available for use at higher mounting heights or with applications requiring wider luminaire spacing and **distributions for strict lighting control. If you have been searching for a stylish solution for your site and area applications, choose a ten... Form Ten from Gardco**

Project: \_\_\_\_\_  
 Location: \_\_\_\_\_  
 Cat.No: \_\_\_\_\_  
 Type: \_\_\_\_\_  
 Lumens: \_\_\_\_\_ Qty: \_\_\_\_\_  
 Notes: \_\_\_\_\_

Ordering guide

Prefix	Optical system	Nominal lumens selection (See lumen table for specific values)	CRI/CCT Combination	Generation code	Optical distribution	Shielding	Mounting	Voltage							
S-CP20	20" cylindrical post top luminaire	P Precision optics	P01 <sup>3,4</sup> 2,500	P09 16,500	830 80CRI, 3,000K	G1 Gen 1	2 Type 2 3 Type 3 3W <sup>6</sup> Type 3 wide 4FT <sup>6</sup> Type 4 forward throw (S&A 2-20 klm) 4 <sup>7</sup> Type 4 (roadway 20-34klm) 5 Type 5	- Leave blank to omit option	T3 Mounts to a 3"x4" tenon (standard)	120 120V					
			P02 <sup>3,4</sup> 3,500	P10 18,000	840 80CRI, 4,000K					208 208V					
			P03 <sup>3</sup> 5,000	P11 20,000	740 70CRI, 4,000K					240 240V					
			P04 <sup>3</sup> 6,000	P12 22,000	750 70CRI, 5,000K					277 277V					
S-MP20	20" semi-spherical post top luminaire	P Precision optics	P05 <sup>5</sup> 8,000	P13 25,000	822 <sup>1</sup> 80CRI, 2,200K	G1 Gen 1	2 Type 2 3 Type 3 4 Type 4 5 Type 5	HIS <sup>9</sup> Internal house side shield	T2 Mounts to a 2-3/8"x4" tenon (must be ordered and shipped as a separate accessory)	120-277V					
			P06 <sup>5</sup> 10,000	P14 27,500	827 <sup>1</sup> 80CRI, 2,700K					347 347V					
			P07 12,500	P15 30,000	835 <sup>1</sup> 80CRI, 3,500K					480 480V					
			P08 15,000	P16 34,000	750 <sup>1</sup> 70CRI, 5,000K					HVU 374-480V					
			C <sup>5</sup> Comfort optics	C01 <sup>8</sup> 2,000	C06 10,000					830 80CRI, 3,000K	G1 Gen 1	2 Type 2 3 Type 3 4 Type 4 5 Type 5	(HIS not available for Comfort)	T4 4" transition fitter (accessory) T5 5" transition fitter (accessory)	374-480V
				C02 3,000	C07 13,000					840 80CRI, 4,000K					
				C03 5,000	C08 15,000					827 <sup>1</sup> 80CRI, 2,700K					
				C04 6,500	C09 16,000					835 <sup>1</sup> 80CRI, 3,500K					
C05 8,000	C10 18,000	750 <sup>1</sup> 70CRI, 5,000K													

Driver option	Dimming controls <sup>2</sup>	Lighting controls	Surge protection	Optional accent color	Primary finish
010V 0-10V	- DLEA Leave blank to omit option Dimming leads externally accessible (controls by others)	- Leave blank to omit option	- Standard 10KVA	- Leave blank to omit option	BK Black
	FAWS Field adjustable wattage selector BL50L2 PIR motion response dim to 50% L2 lens BL50L3 PIR motion response dim to 50% L3 lens BL50MW <sup>3</sup> Microwave motion sensor factory set at 50% dimming	TLRD7 Twist lock receptacle 7-pin TLRPC <sup>8</sup> Twist lock receptacle with photocell	SP2 Increased 20KVA Fusing - Leave blank to omit option	BK Black BZ Bronze DG Dark gray MG Medium gray WH White BE8TX Royal blue BE6TX Ocean blue RD4TX Scarlet RD2TX Burgundy GN Green GN4TX Blue green GN6TX Forest green GN8TX Dark forest green BG2TX Sandstone SC <sup>1</sup> Special color	BZ Bronze DG Dark gray MG Medium gray WH White BE8TX Royal blue BE6TX Ocean blue RD4TX Scarlet RD2TX Burgundy GN Green GN4TX Blue green GN6TX Forest green GN8TX Dark forest green BG2TX Sandstone SC <sup>1</sup> Special color
DALI SR/DALI	- Leave blank to omit option CS50 Security 50 % dimming, 7 hours CM50 Median 50 % dimming, 8 hours CS30 Security 30 % dimming, 7 hours CM30 Median 30 % dimming, 8 hours SRDR SR driver connected to Zhaga socket (D4i) WIAPLW Wireless Interact low sensor (7-15' mounting height), white housing WIAPLB Wireless Interact low sensor (7-15' mounting height), black housing WIAPHW Wireless Interact high sensor (15-40' mounting height), white housing WIAPHB Wireless Interact high sensor (15-40' mounting height), black housing		F1 <sup>6</sup> Single fuse (120, 277, 347VAC) F3 <sup>6</sup> Double pull fuse (208, 240, 480VAC)		

1. Extended leadtime, consult factory.  
 2. Not available with other dimming control options (mutually exclusive).  
 3. Not available at HVU (347-480V).  
 4. Not available with DALI at 120-277V (UNV); Only 0-10V.  
 5. Not available with DALI at 347-480V (HVU); Only 0-10V.

6. Available only with lumen selections P01-P11.  
 7. Available only with lumen selections P12-P16.  
 8. Must specify input voltage. Not allowed with UNV or HVU.  
 9. P11, P15, P16 limited to 30°C ambient with shielding.

# Form Ten Post top

## Form Ten Post Top Accessories

### Mounting Accessories

**Note:** Standard luminaire mounts to 3"Ø x 4" tenon

Accessory Code	Description
T2	T2 Tenon Adapter. Mounts to a 2-3/8"x4" tenon.
T4-(F)	4" OD Pole transition fitter. Must select finish (F).
T5-(F)	5" OD Pole transition fitter. Must select finish (F).

### Controls Accessories

Accessory Code	Description
FS1R-100	Programming Remote for BL50L2/L3
IRT9015	Handheld remote for grouping and configuration of wireless Interact WIAP

### Fusing Accessories

**Note:** Must provide input voltage

Accessory Code	Description
FP1	Pole Fusing Single (120, 277, or 347VAC)
FP3	Pole Fusing Double Pull (208, 340, or 480V)

### Shielding Accessories

**Note:** Shielding accessories can be ordered installed on the luminaire from the factory using HIS option in ordering code.

Accessory Code	Description
HIS-T2-1B	Type 2 Mini Internal Clip-on Shielding x1
HIS-T3-1B	Type 3 Mini Internal Clip-on Shielding x1
HIS-T3W-1B	Type 3W Mini Internal Clip-on Shielding x1
HIS-T4FT-1B	Type 4FT Mini Internal Clip-on Shielding x1
HIS-T5-1B	Type 5 Mini Internal Clip-on Shielding x1
HIS-T2-6B	Type 2 Nano Internal Clip-on Shielding x6
HIS-T2-7B	Type 2 Nano Internal Clip-on Shielding x7
HIS-T3-6B	Type 3 Nano Internal Clip-on Shielding x6
HIS-T3-7B	Type 3 Nano Internal Clip-on Shielding x7
HIS-T4-6B	Type 4 Roadway Nano Internal Clip-on Shielding x6
HIS-T4-7B	Type 4 Roadway Nano Internal Clip-on Shielding x7
HIS-T5-6B	Type 5 Nano Internal Clip-on Shielding x6
HIS-T5-7B	Type 5 Nano Internal Clip-on Shielding x7

### Recommended mounting

4" pole with a 3" diameter tenon

**Mounting to a 3" Pole**  
No accessory required

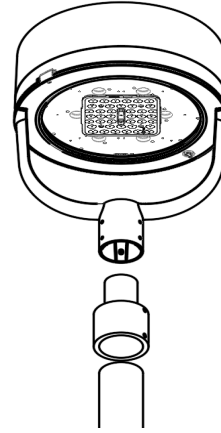
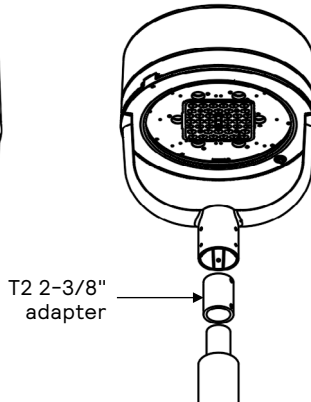
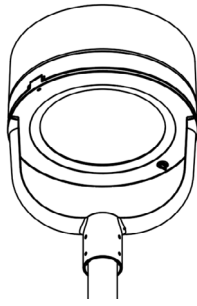
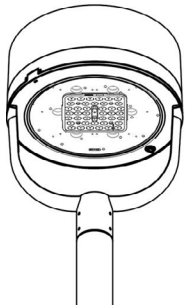

Transition Fitter

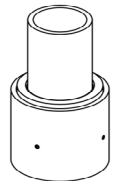
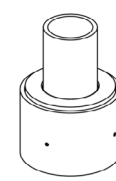

5" to 3"  
T5 transition fitter CP/MP20

4" to 3"  
T4 transition fitter CP/MP20

### Textured finishes

<b>BK</b> Black	<b>BZ</b> Bronze	<b>DG</b> Dark Gray	<b>MG</b> Medium Gray	<b>WH</b> White
<b>BE2TX</b> Midnight Blue	<b>BE6TX</b> Ocean Blue	<b>BE8TX</b> Royal Blue	<b>RD2TX</b> Burgundy	<b>RD4TX</b> Scarlet
<b>GN</b> Green	<b>GN4TX</b> Blue Green	<b>GN6TX</b> Forest Green	<b>GN8TX</b> Dark Forest Green	<b>BG2TX</b> Sandstone

### Semi-spherical post top

Ex: Burgundy primary color with White accent

### Cylindrical post top

Ex: Black primary color with Medium Gray accent



Accent color available for bottom and side

# Form Ten Post top

## FormTen post top precision optics lumen values

Perf. Package	System Watts	Dist. Type	3000K			4000K			5000K			3000K			4000K		
			70 CRI			70 CRI			70 CRI			80 CRI			80 CRI		
			Lumen Output	BUG Rating	Efficacy (LPW)	Lumen Output	BUG Rating	Efficacy (LPW)	Lumen Output	BUG Rating	Efficacy (LPW)	Lumen Output	BUG Rating	Efficacy (LPW)	Lumen Output	BUG Rating	Efficacy (LPW)
P01	14	2	2,242	B1-U0-G1	156	2,335	B1-U0-G1	163	2,335	B1-U0-G1	163	2,017	B1-U0-G1	141	2,148	B1-U0-G1	150
		3	2,281	B1-U0-G1	159	2,376	B1-U0-G1	166	2,376	B1-U0-G1	166	2,052	B1-U0-G1	143	2,186	B1-U0-G1	152
		3W	2,257	B1-U0-G1	157	2,352	B1-U0-G1	164	2,352	B1-U0-G1	164	2,032	B1-U0-G1	142	2,163	B1-U0-G1	151
		4	-	-	-	-	-	-	-	-	-	-	-	-	-	-	-
		4FT	2,274	B1-U0-G1	159	2,369	B1-U0-G1	165	2,369	B1-U0-G1	165	2,047	B1-U0-G1	143	2,180	B1-U0-G1	152
		5	2,314	B2-U0-G1	161	2,410	B2-U0-G1	168	2,410	B2-U0-G1	168	2,082	B2-U0-G1	145	2,217	B2-U0-G1	155
P02	19	2	2,978	B1-U0-G1	156	3,102	B1-U0-G1	162	3,102	B1-U0-G1	162	2,680	B1-U0-G1	140	2,854	B1-U0-G1	149
		3	3,029	B1-U0-G1	158	3,155	B1-U0-G1	165	3,155	B1-U0-G1	165	2,726	B1-U0-G1	143	2,903	B1-U0-G1	152
		3W	2,999	B1-U0-G1	157	3,123	B1-U0-G1	163	3,123	B1-U0-G1	163	2,699	B1-U0-G1	141	2,874	B1-U0-G1	150
		4	-	-	-	-	-	-	-	-	-	-	-	-	-	-	-
		4FT	3,021	B1-U0-G1	158	3,147	B1-U0-G1	164	3,147	B1-U0-G1	164	2,719	B1-U0-G1	142	2,895	B1-U0-G1	151
		5	3,073	B2-U0-G1	161	3,201	B2-U0-G1	167	3,201	B2-U0-G1	167	2,766	B2-U0-G1	145	2,945	B2-U0-G1	154
P03	27	2	4,025	B1-U0-G1	150	4,193	B1-U0-G1	157	4,193	B1-U0-G1	157	3,623	B1-U0-G1	135	3,858	B1-U0-G1	144
		3	4,095	B1-U0-G1	153	4,266	B1-U0-G1	159	4,266	B1-U0-G1	159	3,686	B1-U0-G1	138	3,925	B1-U0-G1	147
		3W	4,054	B1-U0-G1	151	4,223	B1-U0-G1	158	4,223	B1-U0-G1	158	3,648	B1-U0-G1	136	3,885	B1-U0-G1	145
		4	-	-	-	-	-	-	-	-	-	-	-	-	-	-	-
		4FT	4,084	B1-U0-G2	153	4,254	B1-U0-G2	159	4,254	B1-U0-G2	159	3,676	B1-U0-G1	137	3,914	B1-U0-G1	146
		5	4,155	B3-U0-G2	155	4,328	B3-U0-G2	162	4,328	B3-U0-G2	162	3,739	B3-U0-G1	140	3,982	B3-U0-G2	149
P04	34	2	5,086	B1-U0-G1	149	5,298	B1-U0-G1	155	5,298	B1-U0-G1	155	4,577	B1-U0-G1	134	4,874	B1-U0-G1	143
		3	5,174	B1-U0-G1	152	5,390	B1-U0-G1	158	5,390	B1-U0-G1	158	4,657	B1-U0-G1	137	4,958	B1-U0-G1	145
		3W	5,122	B1-U0-G2	150	5,335	B1-U0-G2	156	5,335	B1-U0-G2	156	4,610	B1-U0-G1	135	4,908	B1-U0-G2	144
		4	-	-	-	-	-	-	-	-	-	-	-	-	-	-	-
		4FT	5,160	B1-U0-G2	151	5,375	B1-U0-G2	158	5,375	B1-U0-G2	158	4,644	B1-U0-G2	136	4,945	B1-U0-G2	145
		5	5,249	B3-U0-G2	154	5,468	B3-U0-G2	160	5,468	B3-U0-G2	160	4,724	B3-U0-G2	139	5,031	B3-U0-G2	147
P05	44	2	6,408	B2-U0-G2	147	6,675	B2-U0-G2	153	6,675	B2-U0-G2	153	5,767	B2-U0-G2	132	6,141	B2-U0-G2	141
		3	6,519	B2-U0-G1	149	6,790	B2-U0-G1	156	6,790	B2-U0-G1	156	5,867	B1-U0-G1	134	6,247	B1-U0-G1	143
		3W	6,453	B1-U0-G2	148	6,722	B1-U0-G2	154	6,722	B1-U0-G2	154	5,807	B1-U0-G2	133	6,184	B1-U0-G2	142
		4	-	-	-	-	-	-	-	-	-	-	-	-	-	-	-
		4FT	6,501	B1-U0-G2	149	6,772	B1-U0-G2	155	6,772	B1-U0-G2	155	5,851	B1-U0-G2	134	6,230	B1-U0-G2	143
		5	6,613	B3-U0-G2	151	6,889	B3-U0-G2	158	6,889	B3-U0-G2	158	5,952	B3-U0-G2	136	6,338	B3-U0-G2	145
P06	63	2	8,638	B2-U0-G2	137	8,998	B2-U0-G2	142	8,998	B2-U0-G2	142	7,775	B2-U0-G2	123	8,278	B2-U0-G2	131
		3	8,788	B2-U0-G2	139	9,154	B2-U0-G2	145	9,154	B2-U0-G2	145	7,909	B2-U0-G2	125	8,422	B2-U0-G2	133
		3W	8,699	B2-U0-G2	138	9,062	B2-U0-G2	143	9,062	B2-U0-G2	143	7,829	B2-U0-G2	124	8,337	B2-U0-G2	132
		4	-	-	-	-	-	-	-	-	-	-	-	-	-	-	-
		4FT	8,764	B1-U0-G2	139	9,129	B2-U0-G2	144	9,129	B2-U0-G2	144	7,888	B1-U0-G2	125	8,399	B1-U0-G2	133
		5	8,916	B4-U0-G3	141	9,287	B4-U0-G3	147	9,287	B4-U0-G3	147	8,024	B3-U0-G2	127	8,544	B3-U0-G2	135
P07	79	2	10,598	B2-U0-G2	134	11,040	B2-U0-G2	140	11,040	B2-U0-G2	140	9,539	B2-U0-G2	121	10,157	B2-U0-G2	129
		3	10,782	B2-U0-G2	136	11,231	B2-U0-G2	142	11,231	B2-U0-G2	142	9,704	B2-U0-G2	123	10,333	B2-U0-G2	131
		3W	10,673	B2-U0-G3	135	11,118	B2-U0-G3	141	11,118	B2-U0-G3	141	9,606	B2-U0-G2	122	10,228	B2-U0-G2	129
		4	-	-	-	-	-	-	-	-	-	-	-	-	-	-	-
		4FT	10,752	B2-U0-G3	136	11,200	B2-U0-G3	142	11,200	B2-U0-G3	142	9,677	B2-U0-G3	122	10,304	B2-U0-G3	130
		5	10,939	B4-U0-G3	138	11,395	B4-U0-G3	144	11,395	B4-U0-G3	144	9,845	B4-U0-G3	125	10,483	B4-U0-G3	133
P08	89	2	11,899	B3-U0-G3	134	12,395	B3-U0-G3	139	12,395	B3-U0-G3	139	10,709	B2-U0-G2	120	11,404	B3-U0-G3	128
		3	12,106	B2-U0-G2	136	12,610	B2-U0-G2	142	12,610	B2-U0-G2	142	10,895	B2-U0-G2	122	11,601	B2-U0-G2	130
		3W	11,983	B2-U0-G3	135	12,483	B2-U0-G3	140	12,483	B2-U0-G3	140	10,785	B2-U0-G3	121	11,484	B2-U0-G3	129
		4	-	-	-	-	-	-	-	-	-	-	-	-	-	-	-
		4FT	12,072	B2-U0-G3	136	12,575	B2-U0-G3	141	12,575	B2-U0-G3	141	10,865	B2-U0-G3	122	11,569	B2-U0-G3	130
		5	12,282	B4-U0-G3	138	12,793	B4-U0-G3	144	12,793	B4-U0-G3	144	11,053	B4-U0-G3	124	11,770	B4-U0-G3	132
P09	103	2	13,416	B3-U0-G3	130	13,975	B3-U0-G3	136	13,975	B3-U0-G3	136	12,074	B3-U0-G3	117	12,857	B3-U0-G3	125
		3	13,648	B3-U0-G3	133	14,217	B3-U0-G3	138	14,217	B3-U0-G3	138	12,284	B2-U0-G2	119	13,080	B2-U0-G2	127
		3W	13,510	B2-U0-G3	131	14,073	B2-U0-G3	137	14,073	B2-U0-G3	137	12,159	B2-U0-G3	118	12,947	B2-U0-G3	126
		4	-	-	-	-	-	-	-	-	-	-	-	-	-	-	-
		4FT	13,611	B2-U0-G3	132	14,178	B2-U0-G3	138	14,178	B2-U0-G3	138	12,250	B2-U0-G3	119	13,044	B2-U0-G3	127
		5	13,847	B4-U0-G3	134	14,424	B4-U0-G3	140	14,424	B4-U0-G3	140	12,462	B4-U0-G3	121	13,270	B4-U0-G3	129

# Form Ten Post top

FormTen post top precision optics lumen values (continued)

Perf. Package	System Watts	Dist. Type	3000K			4000K			5000K			3000K			4000K		
			70 CRI			70 CRI			70 CRI			80 CRI			80 CRI		
			Lumen Output	BUG Rating	Efficacy (LPW)	Lumen Output	BUG Rating	Efficacy (LPW)	Lumen Output	BUG Rating	Efficacy (LPW)	Lumen Output	BUG Rating	Efficacy (LPW)	Lumen Output	BUG Rating	Efficacy (LPW)
P10	118	2	14,938	B3-U0-G3	127	15,560	B3-U0-G3	132	15,560	B3-U0-G3	132	13,444	B3-U0-G3	114	14,315	B3-U0-G3	121
		3	15,197	B3-U0-G3	129	15,830	B3-U0-G3	134	15,830	B3-U0-G3	134	13,677	B3-U0-G3	116	14,563	B3-U0-G3	123
		3W	15,043	B3-U0-G3	127	15,670	B3-U0-G3	133	15,670	B3-U0-G3	133	13,539	B2-U0-G3	115	14,416	B3-U0-G3	122
		4	-	-	-	-	-	-	-	-	-	-	-	-	-	-	-
		4FT	15,155	B2-U0-G3	128	15,786	B2-U0-G3	134	15,786	B2-U0-G3	134	13,639	B2-U0-G3	116	14,523	B2-U0-G3	123
		5	15,418	B4-U0-G3	131	16,060	B4-U0-G3	136	16,060	B4-U0-G3	136	13,876	B4-U0-G3	118	14,775	B4-U0-G3	125
P11	136	2	17,077	B3-U0-G3	126	17,788	B3-U0-G3	131	17,788	B3-U0-G3	131	15,369	B3-U0-G3	113	16,365	B3-U0-G3	120
		3	17,372	B3-U0-G3	128	18,096	B3-U0-G3	133	18,096	B3-U0-G3	133	15,635	B3-U0-G3	115	16,649	B3-U0-G3	122
		3W	17,197	B3-U0-G3	126	17,913	B3-U0-G3	132	17,913	B3-U0-G3	132	15,477	B3-U0-G3	114	16,480	B3-U0-G3	121
		4	-	-	-	-	-	-	-	-	-	-	-	-	-	-	-
		4FT	17,325	B2-U0-G3	127	18,047	B2-U0-G3	133	18,047	B2-U0-G3	133	15,592	B2-U0-G3	115	16,603	B2-U0-G3	122
		5	17,625	B4-U0-G3	130	18,359	B5-U0-G3	135	18,359	B5-U0-G3	135	15,863	B4-U0-G3	117	16,891	B4-U0-G3	124
P12	129	2	17,903	B3-U0-G3	139	18,649	B3-U0-G3	145	18,649	B3-U0-G3	145	16,113	B3-U0-G3	125	17,157	B3-U0-G3	133
		3	18,231	B3-U0-G3	141	18,990	B3-U0-G3	147	18,990	B3-U0-G3	147	16,408	B3-U0-G3	127	17,471	B3-U0-G3	135
		3W	-	-	-	-	-	-	-	-	-	-	-	-	-	-	-
		4	18,628	B2-U0-G3	144	19,404	B2-U0-G3	150	19,404	B2-U0-G3	150	16,765	B2-U0-G3	130	17,852	B2-U0-G3	138
		4FT	-	-	-	-	-	-	-	-	-	-	-	-	-	-	-
		5	18,549	B5-U0-G3	144	19,322	B5-U0-G3	150	19,322	B5-U0-G3	150	16,694	B4-U0-G3	129	17,776	B5-U0-G3	138
P13	151	2	20,303	B3-U0-G3	134	21,149	B3-U0-G3	140	21,149	B3-U0-G3	140	18,272	B3-U0-G3	121	19,457	B3-U0-G3	129
		3	20,674	B3-U0-G3	137	21,536	B3-U0-G3	143	21,536	B3-U0-G3	143	18,607	B3-U0-G3	123	19,813	B3-U0-G3	131
		3W	-	-	-	-	-	-	-	-	-	-	-	-	-	-	-
		4	21,124	B2-U0-G4	140	22,005	B2-U0-G4	146	22,005	B2-U0-G4	146	19,012	B2-U0-G3	126	20,244	B2-U0-G3	134
		4FT	-	-	-	-	-	-	-	-	-	-	-	-	-	-	-
		5	21,035	B5-U0-G3	139	21,912	B5-U0-G3	145	21,912	B5-U0-G3	145	18,932	B5-U0-G3	125	20,159	B5-U0-G3	134
P14	171	2	22,329	B3-U0-G3	131	23,260	B3-U0-G3	136	23,260	B3-U0-G3	136	20,096	B3-U0-G3	118	21,399	B3-U0-G3	125
		3	22,738	B3-U0-G3	133	23,686	B3-U0-G3	139	23,686	B3-U0-G3	139	20,464	B3-U0-G3	120	21,791	B3-U0-G3	127
		3W	-	-	-	-	-	-	-	-	-	-	-	-	-	-	-
		4	23,233	B2-U0-G4	136	24,201	B2-U0-G4	142	24,201	B2-U0-G4	142	20,910	B2-U0-G3	122	22,265	B2-U0-G4	130
		4FT	-	-	-	-	-	-	-	-	-	-	-	-	-	-	-
		5	23,135	B5-U0-G3	135	24,099	B5-U0-G3	141	24,099	B5-U0-G3	141	20,821	B5-U0-G3	122	22,171	B5-U0-G3	130
P15	204	2	25,861	B3-U0-G3	127	26,939	B4-U0-G4	132	26,939	B4-U0-G4	132	23,275	B3-U0-G3	114	24,784	B3-U0-G3	121
		3	26,335	B3-U0-G3	129	27,432	B3-U0-G3	134	27,432	B3-U0-G3	134	23,701	B3-U0-G3	116	25,237	B3-U0-G3	124
		3W	-	-	-	-	-	-	-	-	-	-	-	-	-	-	-
		4	26,908	B3-U0-G4	132	28,029	B3-U0-G4	137	28,029	B3-U0-G4	137	24,217	B2-U0-G4	119	25,787	B3-U0-G4	126
		4FT	-	-	-	-	-	-	-	-	-	-	-	-	-	-	-
		5	26,794	B5-U0-G4	131	27,911	B5-U0-G4	137	27,911	B5-U0-G4	137	24,115	B5-U0-G3	118	25,678	B5-U0-G3	126
P16	224	2	27,825	B4-U0-G4	124	28,985	B4-U0-G4	129	28,985	B4-U0-G4	129	25,043	B3-U0-G3	112	26,666	B4-U0-G4	119
		3	28,335	B3-U0-G3	126	29,515	B3-U0-G3	132	29,515	B3-U0-G3	132	25,501	B3-U0-G3	114	27,154	B3-U0-G3	121
		3W	-	-	-	-	-	-	-	-	-	-	-	-	-	-	-
		4	28,952	B3-U0-G4	129	30,158	B3-U0-G4	135	30,158	B3-U0-G4	135	26,056	B3-U0-G4	116	27,745	B3-U0-G4	124
		4FT	-	-	-	-	-	-	-	-	-	-	-	-	-	-	-
		5	28,829	B5-U0-G4	129	30,030	B5-U0-G4	134	30,030	B5-U0-G4	134	25,946	B5-U0-G3	116	27,628	B5-U0-G4	123

# Form Ten Post top

## FormTen post top comfort optics lumen values

Perf. Package	System Watts	Dist. Type	3000K			4000K		
			80 CRI			80 CRI		
			Lumen Output	BUG Rating	Efficacy (LPW)	Lumen Output	BUG Rating	Efficacy (LPW)
C01	14	2	1,579	B1-U0-G1	110	1,688	B1-U0-G1	117
		3	1,601	B1-U0-G1	111	1,712	B1-U0-G1	119
		4	1,692	B1-U0-G1	117	1,808	B1-U0-G1	125
		5	1,453	B1-U0-G1	102	1,553	B1-U0-G1	109
C02	24	2	2,666	B1-U0-G1	109	2,850	B1-U0-G1	117
		3	2,704	B1-U0-G1	111	2,890	B1-U0-G1	119
		4	2,856	B1-U0-G1	117	3,053	B1-U0-G1	125
		5	2,469	B2-U0-G1	102	2,639	B2-U0-G1	110
C03	34	2	3,685	B2-U0-G2	107	3,939	B2-U0-G2	115
		3	3,737	B2-U0-G2	109	3,994	B2-U0-G2	116
		4	3,947	B2-U0-G2	115	4,219	B2-U0-G2	123
		5	3,414	B2-U0-G2	99	3,650	B2-U0-G2	106
C04	49	2	5,060	B2-U0-G2	104	5,409	B2-U0-G2	112
		3	5,131	B2-U0-G2	106	5,485	B2-U0-G2	113
		4	5,420	B2-U0-G2	112	5,793	B2-U0-G2	119
		5	4,795	B3-U0-G2	100	5,125	B3-U0-G2	107
C05	59	2	6,228	B2-U0-G2	105	6,657	B2-U0-G2	112
		3	6,315	B2-U0-G2	106	6,751	B2-U0-G2	114
		4	6,671	B2-U0-G2	112	7,131	B2-U0-G2	120
		5	6,002	B3-U0-G2	101	6,416	B3-U0-G2	108
C06	75	2	7,637	B3-U0-G3	103	8,163	B3-U0-G3	110
		3	7,744	B3-U0-G3	104	8,278	B3-U0-G3	111
		4	8,180	B3-U0-G3	110	8,744	B3-U0-G3	117
		5	7,270	B3-U0-G3	98	7,771	B3-U0-G3	104
C07	104	2	10,059	B3-U0-G3	97	10,753	B3-U0-G3	103
		3	10,201	B3-U0-G3	98	10,904	B3-U0-G3	105
		4	10,774	B3-U0-G3	104	11,517	B3-U0-G3	111
		5	9,973	B4-U0-G3	98	10,660	B4-U0-G3	105
C08	115	2	10,692	B3-U0-G3	93	11,429	B3-U0-G3	100
		3	10,842	B3-U0-G3	95	11,590	B3-U0-G3	101
		4	11,452	B3-U0-G3	100	12,242	B3-U0-G3	107
		5	10,473	B4-U0-G3	91	11,196	B4-U0-G3	98
C09	134	2	12,187	B3-U0-G3	91	13,027	B3-U0-G3	97
		3	12,358	B3-U0-G3	92	13,211	B3-U0-G3	98
		4	13,053	B3-U0-G3	97	13,953	B3-U0-G3	104
		5	12,183	B4-U0-G3	90	13,024	B4-U0-G3	96
C10	154	2	13,477	B3-U0-G3	87	14,407	B3-U0-G3	93
		3	13,667	B3-U0-G3	89	14,610	B3-U0-G3	95
		4	14,436	B3-U0-G3	93	15,431	B3-U0-G3	100
		5	13,493	B4-U0-G3	88	14,423	B4-U0-G3	94

# Form Ten Post top

## Predicted Lumen Depreciation Data

Predicted performance derived from LED manufacturer's data and engineering design estimates, based on IESNA LM-80 methodology. Actual experience may vary due to field application conditions. L70 is the predicted time when LED performance depreciates to 70% of initial lumen output. Calculated per IESNA TM21-11. Published L70 hours limited to 6 times actual LED test hours

Optic type	Calculated L <sub>70</sub> Hours	L <sub>70</sub> reported per TM-21	Lumen Maintenance % at 60,000 hrs
Precision (P01-P11)	>100,000 hours	>100,000 hours	88.15%
Precision (P12-P16)	89,000 hours	89,000 hours	79.82%
Comfort (C01-C10)	>100,000 hours	>100,000 hours	88.93%

## Precision Optical Distributions

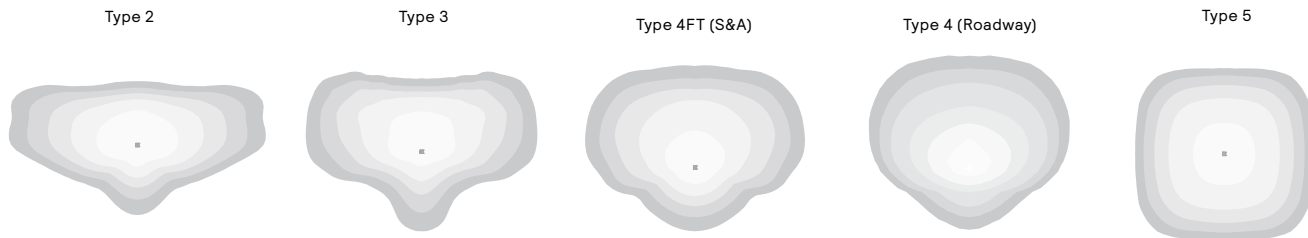

## Comfort Optical Distributions



# Form Ten Post top

## Dimensions

### Post top cylinder

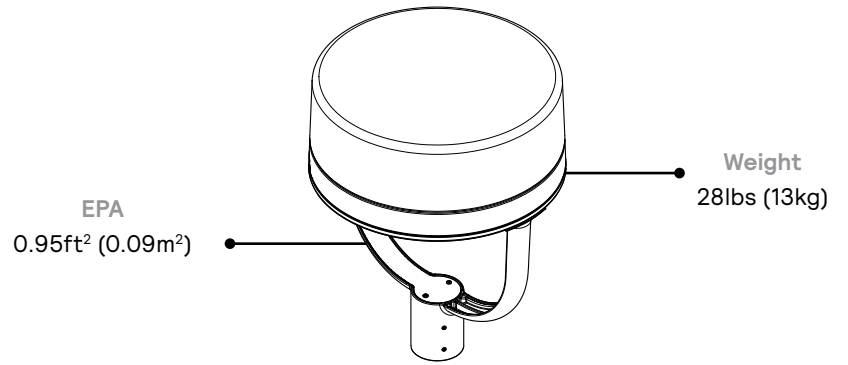
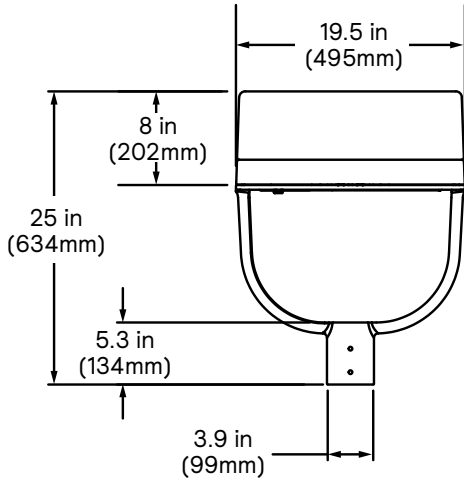

### Post top dome

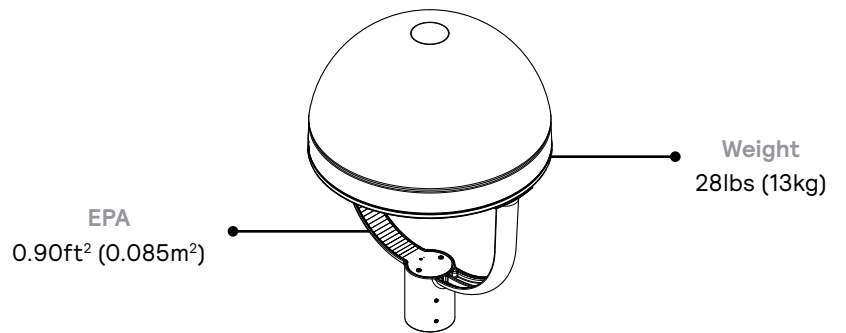
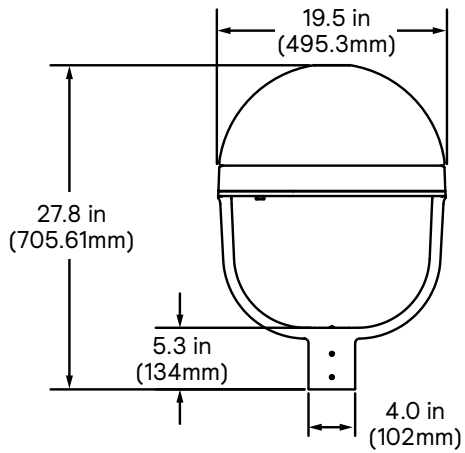

# Form Ten Post top

## Specifications

### Housing

Form Ten Housing is die cast A360.1 aluminum alloy 0.1 (2.5mm) thick. Comprised of LED heatsink and electronic compartment cover to protect vital components from the elements and keep them cool, extending product life. Maintaining the classic style, Form Ten offers two decorative spun aluminum housing tops in cylinder (CA) or dome (MA) shapes mechanically assembled to the housing.

### Mounting

The yoke mount option provides the ability to mount to a variety of poles and tenons. As standard, the Form Ten post top will mount to a Ø3'x4' tenon. T2 mounting selection available for installation on to a 2-3/8" x 4" tenon (must be ordered and shipped as a separate accessory). Also available with transition tenons for 4" and 5" mounting.

### Finish

The thermosetting powder coating provided meets the color requirements of the AAMA 2603 standard. Application of polyester powder coat paint (4 mils/100 microns) with ± 1 mils/24 microns of tolerance. The Thermosetting resins provides a discoloration resistant finish in accordance with the ASTM D2244 standard, as well as luster retention in keeping with the ASTM D523 standard and humidity proof in accordance with the ASTM D2247 standard. The surface treatment achieves a minimum of 2000 hours for salt spray resistant finish in accordance with testing performed and per ASTM B117 standard.

Unique and customizable paint combinations are available to enhance any site.

### Certifications & Listings

UL/cUL wet location Listed to the UL 1598 standard, Suitable for use in ambients from -40°C to 40°C on all configurations. Lumen Packages P01-P08 are available to 50°C. Configurations P11, P15, and P16 with shielding are limited to 30°C. Most Form Ten comfort configurations are qualified under DesignLights Consortium® Premium or Standard category where applicable. Consult DLC Qualified Products list to confirm your specific luminaire selection is approved. CCTs 3000K and warmer are IDA DarkSky compliant.

### LED products manufacturing standard

The electronic components sensitive to electrostatic discharge (ESD) such as light emitting diodes (LEDs) are assembled in compliance with IEC61340-5-1 and ANSI/ESD S20.20 standards so as to eliminate ESD events that could decrease the useful life of the product.

### Quality Control

The manufacturer must provide a written confirmation of its ISO 9001 and ISO 14001 International Quality Standards Certification.

### Vibration resistance

Luminaire is tested and rated Level 1 for normal application (formerly 1.5G) for 100k cycles conforming to standards set forth by ANSI C136.31-2023. Testing includes vibration to 1.5G acceleration in three axes, all performed on the same luminaire.

### Light engine

ComfortEdge Technology provides low-glare, uniform illumination, composed of LEDs strategically positioned on the edge of the optical plate. Light engine luminous opening size optimized to best achieve a balance between lumen output and optical performance with the need to provide visual comfort. Light engine frame ensures contact with housing to provide heat conduction and sealing against the elements.

Precision LED modules are comprised of LEDs mounted to metal clad printed circuit board and sealed to a high-performance UV stabilized optical grade polymer refractor lens to achieve desired distribution, optimized to get maximum spacing, target lumens and a superior lighting uniformity. Modules carry an IP66 rating per ANSI C136.37 and IK09 Impact rating per IEC 62262.

### Optical systems

ComfortEdge technology provides a unique and lower perceived glare lighting solution designed to enhance visual comfort for pedestrian applications. Available in IES distribution types 2, 3, 4 and 5 available up to 17,000 lumens. Precision optics are available for site and area applications type 2, 3W, 4 Forward Throw and T5. Form Ten now offers Type 4 roadway distribution at higher lumen packages to improve street lighting. Other optical distributions available through ETO, contact factory for inquiries. Internal shielding option

available for all precision optics mounts directly to optical plate to provide additional cutoff and address light trespass and requirements around property lines. These can be ordered installed from the factory or separately as an accessory if needed after shipment. All optical systems are performance tested per LM-79 and TM-15 (IESNA) certifying its photometric performance. Luminaire designed with 0% uplight (U0 per IESNA TM-15).

### Driver

High power factor of 90% minimum electronic driver, operating range 50/60 Hz. Auto-adjusting universal voltage input rated for both application line-to-line or line-to-neutral, THD of 20% max.

UNV: 120 to 277VAC HVU: 347 to 480VAC

The current supplying the LEDs will be reduced by the driver if the driver experiences internal overheating as a protection to the LEDs and the electrical components. Output is protected from short circuits, voltage overload and current overload. Automatic recovery after correction.

### Energy saving benefits

System efficacy up to 168 lms/W with significant energy savings over legacy technology and early generation LED luminaires. Optional control options provide added energy savings during unoccupied periods and code compliance.

### Surge protection

Surge protector tested in accordance with ANSI/IEEE C62.45 per ANSI/IEEE C62.41.2 Scenario I Category C High Exposure 10kV/10kA waveforms for Line Ground, Line Neutral and Neutral Ground, and in accordance with U.S. DOE (Department of Energy) MSSLC (Municipal Solid State Street Lighting Consortium) model specification for LED luminaires electrical immunity requirements for High Test Level 10kV/10kA. Optional Fail-On 20kV/10kA SP2 option includes surge protection device that provides extra protection beyond standard 10kV/10kA level.

### Service tag

Each individual luminaire is uniquely identifiable, thanks to the Service Tag application. With a simple scan of a QR code placed on the inside of the mast door, you gain instant access to the luminaire configuration, making installation and maintenance operations faster and easier, no matter the stage of the luminaire's lifetime. Just download the app and register your product right away. For more details visit: [signify.com/servicetag](http://signify.com/servicetag)

### Warranty

Form Ten luminaires feature a 5-year limited warranty. See [signify.com/warranties](http://signify.com/warranties) for complete details and exclusions.

### Controls

#### 0-10V Dimming Control Options

**DLEA:** Access to 0-10V dimming leads supplied through the yoke of the luminaire (for secondary dimming controls by others). Cannot be used with other control options.

**BL50L2/BL50L3:** Motion Response module is mounted integral to luminaire factory pre-programmed to 50% dimming when not ordered with other control options. BL50Lx options are set/operate in the following fashion: The motion sensor is set to a constant 50%. When motion is detected by the PIR sensor, the luminaire returns to full power/light output. Dimming on low is factory set to 50% with 5 minutes default in "full power" prior to dimming back to low. When no motion is detected for 5 minutes, the motion response system reduces the wattage by 50%, to 50% of the normal constant wattage reducing the light level. Other dimming settings can be provided if different dimming levels are required. Contact technical support for details.



# Form Ten Post top

## Specifications (cont'd)

**Infrared Motion Response Lenses (BL50L2/BL50L3):** Lens #2 is designed for mounting heights 8' to 15'. Lens #3 is designed for higher mounting heights up to 20' with a 40' diameter coverage area.

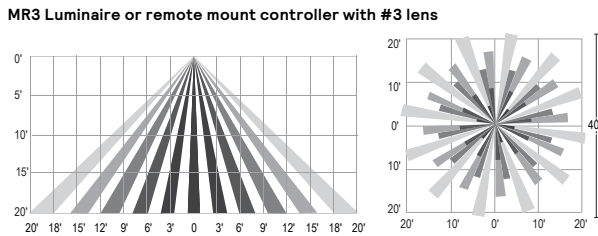
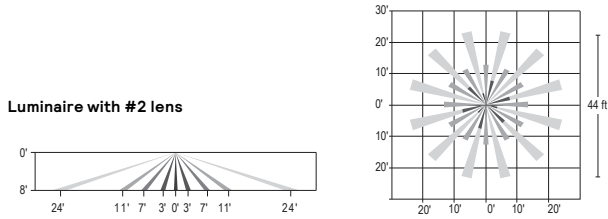

**Microwave Motion Response (BL50MW):** Motion response luminaires include a high frequency microwave sensor, 5.8GHz+/- 75MHz microwave ISM continuous wave band with 360° coverage area, <0.5 mW transmitting power and <1 W standby power. Factory programmed settings dim fixture to 50% with time delay of 5 minutes with no stand-by period. When motion is detected, the luminaire returns to 100% full light output and will remain on full power for 5 minutes.

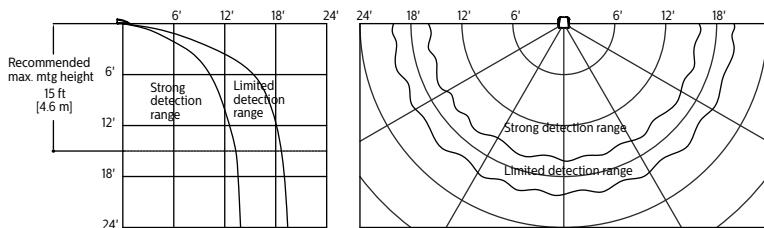

**Field Adjustable Wattage Selector (FAWS):** Luminaire equipped with the ability to manually adjust the wattage in the field to reduce total luminaire lumen output and light levels. Comes pre-set to the highest of 10 output positions. Consult factory for specific dimming settings for each position.

### Sensor Ready(SR)/DALI Control Options

**Automatic Profile Dimming (CS/CM/CE/CA):** Standard dimming profiles provide flexibility towards energy savings goals while optimizing light levels during specific dark hours. Dimming profiles include two dimming settings including dim to 30% or 50% of the total lumen output. Automatic dimming profile scheduled with the following settings:

- **CS50/CS30:** Security for 7 hours night duration (Ex., 11 PM - 6 AM)
- **CM50/CM30:** Median for 8 hours night duration (Ex., 10 PM - 6 AM)

All above profiles are calculated from mid point of the night. Dimming is set for 6 hours after the mid point and 1 or 2 hours before depending of the duration of dimming. Time clock or photocell is required for on/off functionality to allow for midpoint calculation. Cannot be used with other dimming control options.

**Sensor Ready Zhaga Socket Connector (SRDR):** Product is zD4i Certified and equipped with Sensor Ready drivers connected to 4-pin Zhaga Book 18 compliant receptacle designed for sensor and other control system applications. Receptacle is rated IP66 assembly in a compact design that

provides a sealed electrical interface and rated UV resistance, mounted on underside of the luminaire, protective dust cap included. When a controller not provided by Signify is used with Sensor Ready Zhaga socket connector, the controller must be certified to work with the Xitanium SR LED drivers as part of the SR certified program. SRDR can be used with NEMA 7-pin twist lock receptacle, which is mounted on top of the luminaire. D4i certification validates compliance with specifications for data exchange in connected lighting systems, ensuring interoperability, compatibility, and efficient operation. It also assures customers that the device meets industry standards.

**Outdoor Interact:** Scalable connected sensor with integral occupancy and daylight sensing, supports wireless mesh connectivity. Sensor works in the Foundation mode when configured without a gateway or in an Interact Advanced mode if a compatible gateway (can be added later) is used. Interact offers an app, a portal and a broad portfolio of Interact ready Indoor and Outdoor luminaires, lamps and retrofit kits all working on the same system. Startup is implemented via Interact Pro App (available in iOS® or Android®) and Bluetooth® connectivity. The app provides flexibility to choose between a gateway or non gateway mode for setup. Setup with the gateway requires wired Internet access to the gateway. Prepare project configuration steps remotely and use IRT9015 remote accessory (ordered separately) or the App on-site to identify and group devices together. WIAP includes SR driver and SR receptacle. Daylight harvesting supported through dimming - activated via the Interact app. Sensors are available in black or white finish and high or low mounting height lenses. IP66 rated.

For more information on Interact visit:

[www.interact-lighting.com/interactproscalablesystem](http://www.interact-lighting.com/interactproscalablesystem)

### LB or LW low sensor

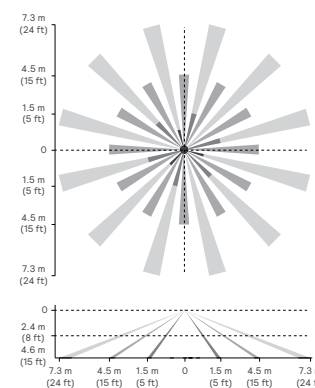

### HB or HW high sensor

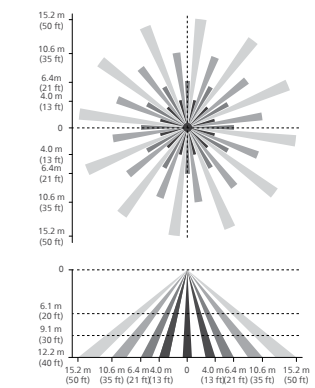

**Note:** The beam patterns shown are intended solely as a general guide and are not to scale. Sensing capabilities and coverage area depend on many factors including the size, speed and direction of travel of persons and vehicles; sensor mounting height; environmental and site conditions; etc.

### Lighting Control Options

**Twist-Lock Receptacle (TLRD7/TLRDPC):** Receptacle with 7 pins enabling dimming and with two extra connections for future use (these connections are capped off at the factory - requires connections to be made in the field), can be used with a twist-lock control device or photoelectric cell or a shorting cap. Use of photocell or shorting cap is required to ensure proper illumination. When specified with receptacle and photoelectric cell (TLRDPC), 7-pin receptacle is supplied and voltage must be specified. When ordering Twist-lock receptacle (TLRD7), photocell or shorting cap is not included.