

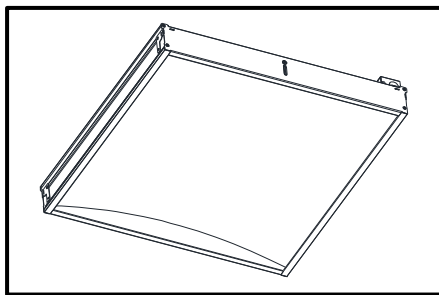

System Overview

These instructions review how to install recessed LED fixtures. Please refer to layout drawings supplied by Ledalite in conjunction with these installation instructions. The graphics and chart below show available aesthetics and configurations with important mounting dimensions.

IMPORTANT: Read all instructions including fixture/sensor wiring AND mechanical details **before** beginning installation.



ArcForm Duo

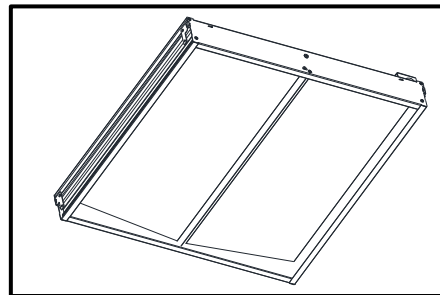

Pique Duo

i **Optional 6' Flex Whip**

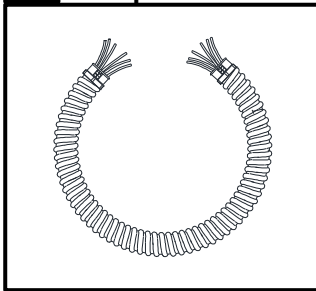

Optional snap in 6' flex whip is prewired at the factory.

i **Drywall Kit Installation Sheet**



Scan or click [Link](#)

Configuration	Length	Width	Height with Standard driver box	Height with Emergency driver box
2X2	23-11/16" [602mm]	23-11/16" [602mm]	4-11/16" [118mm]	5-7/16" [138mm]
1X4	47-11/16" [1211mm]	11-3/4" [298mm]	4-11/16" [118mm]	5-7/16" [138mm]
2X4	47-11/16" [1211mm]	23-11/16" [602mm]	4-11/16" [118mm]	5-7/16" [138mm]

*Compatible with NEMA (G) T-Grid Ceilings

! **ATTENTION: Install in accordance with local and national building and electric codes.**

This equipment has been tested and found to comply with the limits for a Class A digital device, pursuant to part 15 of the FCC Rules. These limits are designed to provide reasonable protection against harmful interference when the equipment is operated in a commercial environment. This equipment generates, uses, and can radiate radio frequency energy and, if not installed and used in accordance with the instruction manual, may cause harmful interference to radio communications. Operation of this equipment in a residential area is likely to cause harmful interference in which case the user will be required to correct the interference at his own expense.

Warning! Shock Hazard!

IMPORTANT:
Disconnect or turn off power before attempting any installation, service or maintenance.



Warning! Shock Hazard!

IMPORTANT:
Fixture must be connected to building ground via the provided ground wire before re-connecting to mains power supply.



Installation

Read all instructions including fixture/sensor wiring mechanical details before beginning installation.

Beware of sharp edges on fixture.

Handle With Care

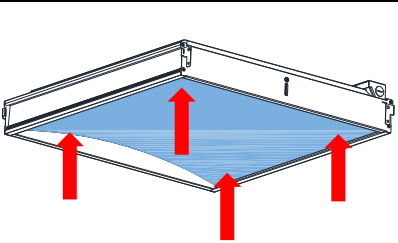

- **Do not put pressure on the lens during installation.**
- Lift using both hands from the edges only.

Handle With Care

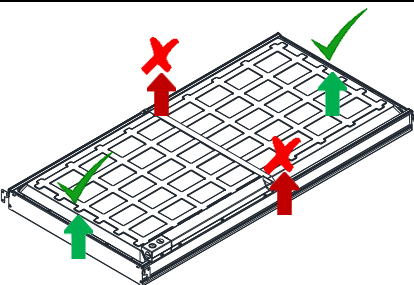

- Do not use cross-strap to lift fixture. (2x4, 1x4)

Installation Notes

Arrange boxed fixtures on floor in specified mounting locations, based on supplied layout drawings. Remove fixtures from boxes.

Power Feed - Standalone

Power feed

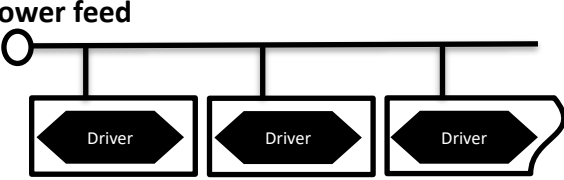

- Every fixture contains its own driver & receives a direct power feed.

Power Feed - Continuous Row

Power feed

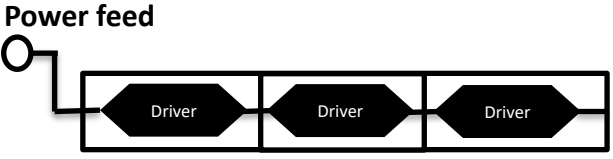

- Serviced with by one power feed. Through wire supplied by others
- See Step 7 for connection option

Tools required - #2 Phillips or #2 Robertson screwdriver

ATTENTION: Install in accordance with local and national building and electric codes.

Preparing and mounting fixture on T-Grid

1 Bend mounting tab

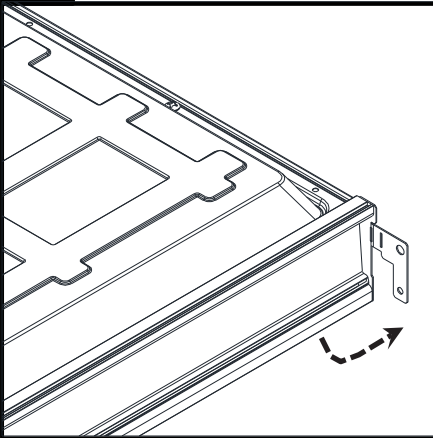

Bend out mounting tab to desired angle on each corner.

2 Place fixture in T-Grid

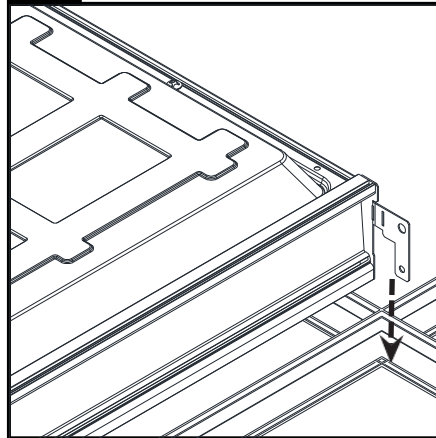

Place fixture in T-Grid.

3 Place fixture in T-Grid

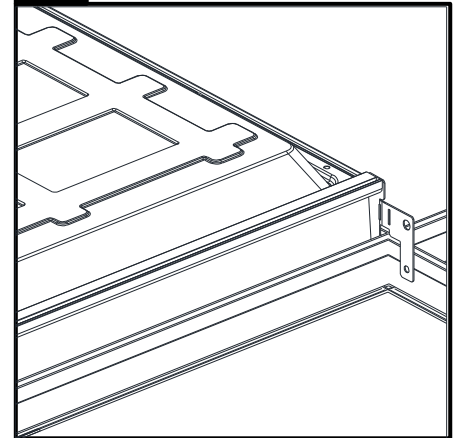

Bend tabs flush against T-Bar to clear ceiling tile.

4 Secure fixture & tie off to structure (six acceptable options)

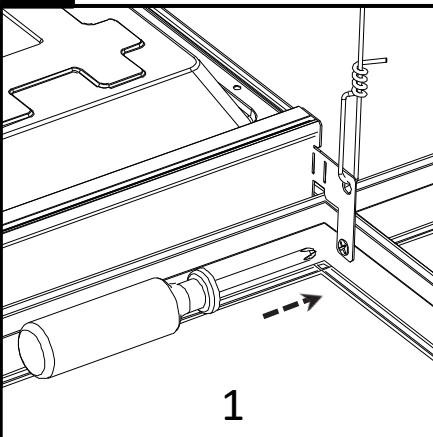

1

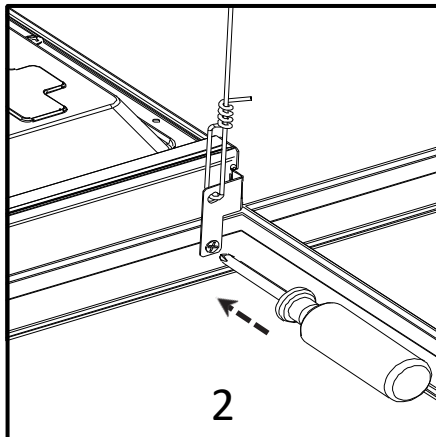

2

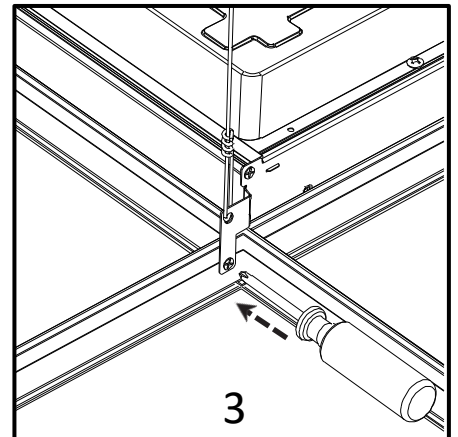

3

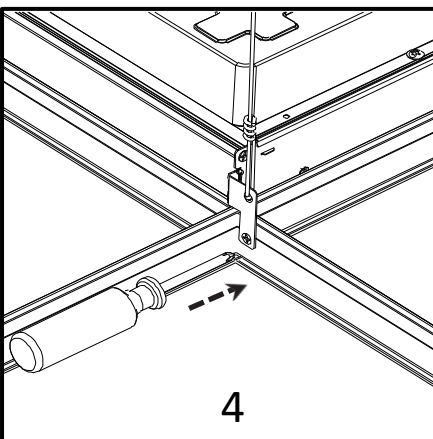

4

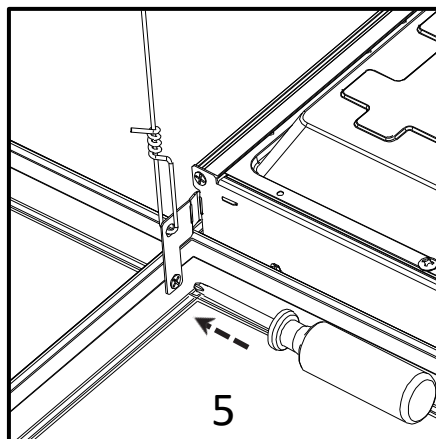

5

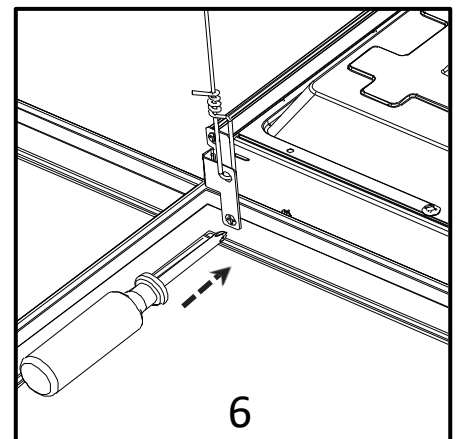

6

Secure fixture to T-Grid with self drilling #8x1/4" sheet metal screw. (supplied by others). Integral mounting clips can accommodate multiple situations where access is limited.

Secure fixture with grid wire or suitable equivalent per national building codes.

! **ATTENTION: Install in accordance with local and national building and electric codes.**

Preparing and mounting fixture on T-Grid

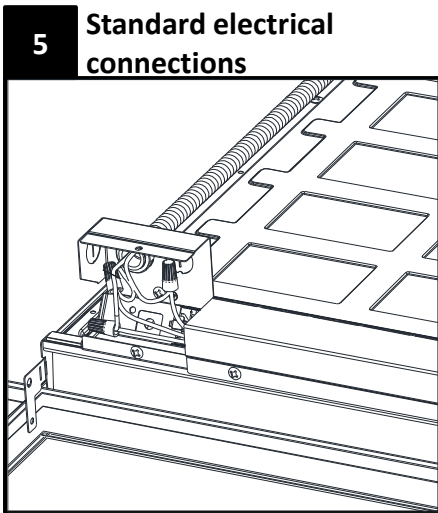

Remove screw using a #2 Phillips OR #2 Robertson screwdriver to open wire access door. Make electrical connections using wire nuts (supplied by others).
Optional 6' flex whip is prewired inside the fixture. Remove from packaging and insert snap-in fitting into driver box.

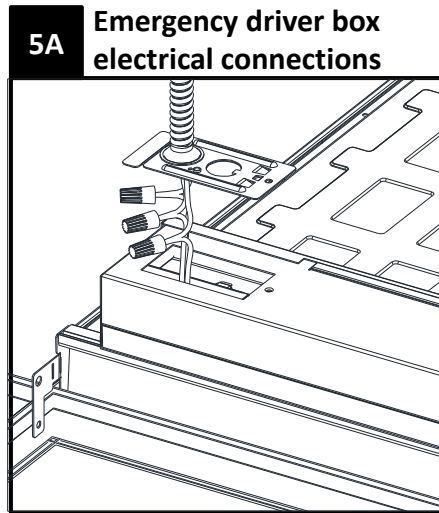

Remove preinstalled wire access cover by sliding towards the end of fixture. Connect power feed using wire nuts (supplied by others) to the leads provided.
Optional 6' flex whip is prewired inside the fixture. Remove from packaging and insert snap-in fitting into wire access cover or knockout.

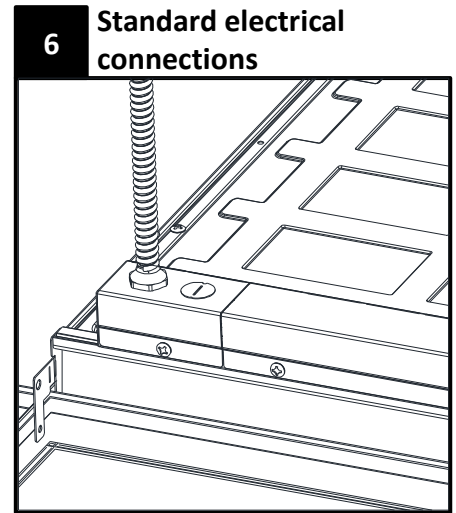

Close access door and reinstall screw using a #2 Phillips OR #2 Robertson screwdriver.

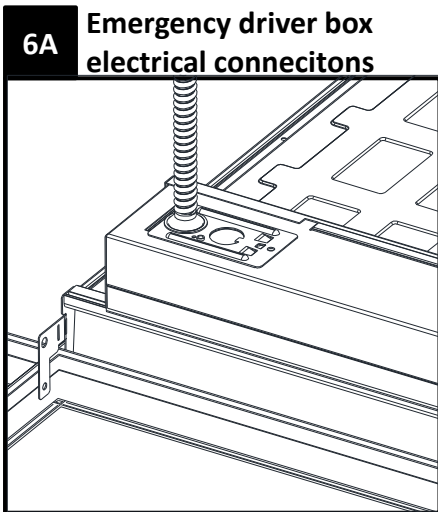

Reinstall wire access cover.

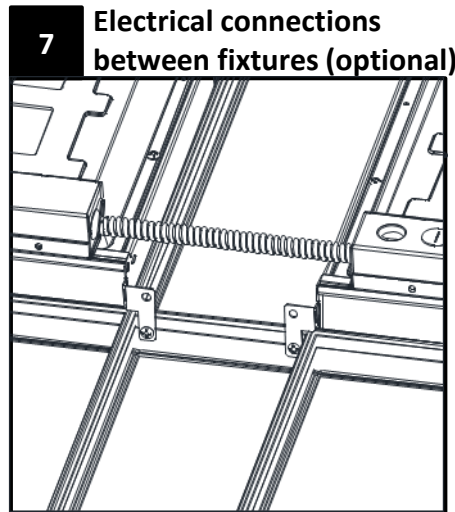

Remove knockouts and feed the wires through electrical conduit (supplied by others). Ensure the correct wire color code is maintained.

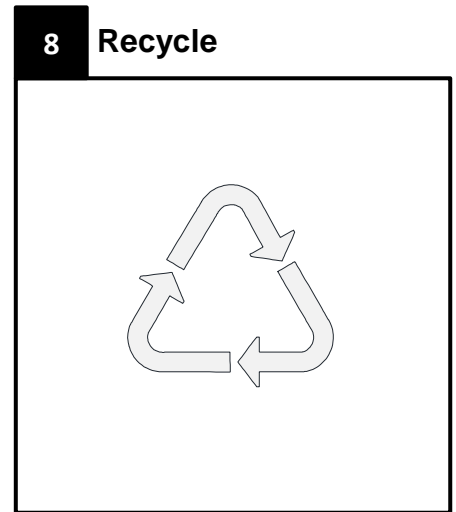

Recycle all packaging materials and unused contents.

! **ATTENTION: Install in accordance with local and national building and electric codes.**

**not for Enterprise or Signify Commissioned projects*

To configure a lighting system with Interact sensors or RF nodes;

- Ensure the luminaires are installed and powered on.
- Download the Interact Pro app from either Apple’s App Store (for iOS) or Google’s Play Store.

Download the Interact Pro app



- Register by tapping **Request access** on the login screen in the app.
- **Click** or **scan** the QR codes below to view instructions for setup.

Interact Pro Foundation Quick Start Guide



Interact Pro Documentation



Interact Pro Advanced Quick Start Guide



Interact Pro Setup Video



Contact Us 1-800-555-0050



! ATTENTION: Install in accordance with local and national building and electric codes.

Interact Pro

Occupancy Sensor Coverage:

Note: Longer dimension of detection area (Y1, Y2) is parallel to shorter dimension of the luminaire.

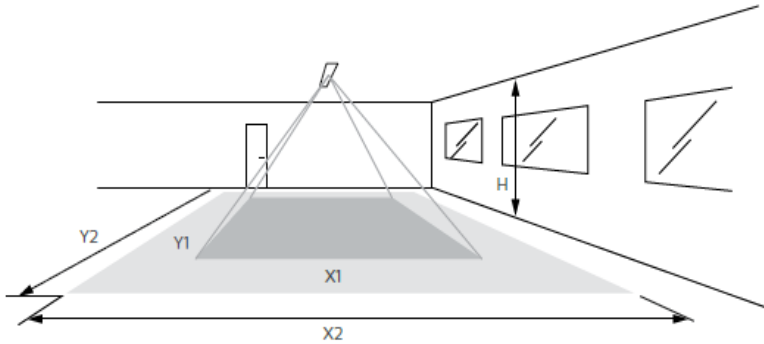

Daylight sensor

The light sensor measures the total amount of light in a circular field of approximately 80% of the PIR detection area. The following aspects should be observed during installation:

- Minimum distance from the window $\geq 2\text{ft}$ (0.6m).
- Prevent light reflections from outside entering the sensor (for example sunlight reflection on a car hood) as this will lead to incorrect light regulation.

As a guideline the formula $0.72 \times H$ can be used to calculate the minimum distance between the window and sensor whereby H is the height from the bottom of the window to the sensor.

Height	Minor movement		Major movement	
	X1	Y1	X2	Y2
2.4 m (7.9 ft)	1.9 m (6.2 ft)	2.9 m (9.5 ft)	2.9 m (9.5 ft)	4.3 m (14.1 ft)
3 m (9.8 ft)	2.4 m (7.9 ft)	3.6 m (11.8 ft)	3.6 m (11.8 ft)	5.4 m (17.7 ft)

The detection area for the movement sensor can be roughly divided into two parts:

- Minor movement (person moving $\leq 3\text{ft/s}$ or 0.9m/s).
- Major movement (person moving $\geq 3\text{ft/s}$ or 0.9m/s).

Photosensor spatial response

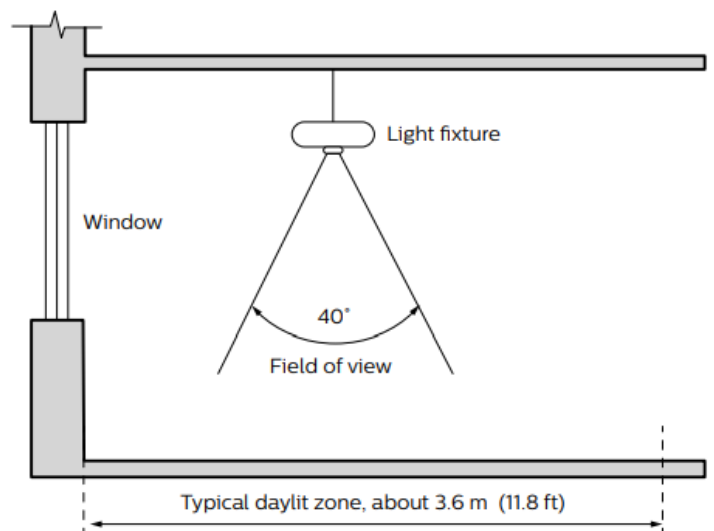

Lutron Sensor Specification Sheets:

- Athena: [Athena Wireless Node Link](#)
- Vive: [Vive Integral Fixture Control Link](#)

! ATTENTION: Install in accordance with local and national building and electric codes.

INSTALLATION

WARNINGS AND INSTRUCTIONS FOR LUMINAIRES

IMPORTANT: THIS PRODUCT MUST BE INSTALLED IN ACCORDANCE WITH THE APPLICABLE INSTALLATION CODE BY A PERSON FAMILIAR WITH THE CONSTRUCTION AND OPERATION OF THE PRODUCT AND THE HAZARDS INVOLVED.

FOR YOUR PROTECTION, YOU MUST CAREFULLY READ ALL WARNINGS AND INSTRUCTIONS IN THEIR ENTIRETY PRIOR TO INSTALLATION, OPERATION, SERVICE OR MAINTENANCE. FAILURE TO DO SO CAN RESULT IN DEATH, PERSONAL INJURY AND PROPERTY DAMAGE. If you do not understand these warnings and instructions, or if additional information is desired, please contact the Customer Care Call Center at 800-555-0050.

- Installation, service and maintenance of luminaires must be performed by a qualified professional and in accordance with all federal, state and local laws, regulations and electrical codes. This professional should be familiar with the construction and operation of this product and any hazards involved. If not qualified, do not attempt installation, service or maintenance.
- To reduce the risk of death, personal injury or property damage from fire, electric shock, falling parts, cuts, abrasions and other hazards, please read all warnings and instructions included with the luminaire, on the luminaire's packaging and affixed to the luminaire itself.
- Maintenance of the luminaires should be performed by person(s) familiar with the luminaire's construction and operation and any hazards involved.



WARNING

RISK OF FIRE, ELECTRIC SHOCK OR PERSONAL INJURY

- Disconnect or turn off power before attempting any installation, service or maintenance.
- Verify that supply voltage is correct by referencing the luminaire label information.
- Make all electrical and ground connections in accordance with the National Electrical Code (NEC) and any other applicable laws, regulations or codes.
- All wiring connections must be capped with UL-approved wire connectors.



WARNING

RISK OF PERSONAL INJURY

- Wear gloves and safety glasses at all times when removing luminaire from carton, installing, servicing or performing maintenance.
- Avoid direct eye exposure to the light source while it is on.



WARNING

RISK OF FIRE OR PERSONAL INJURY

- Keep combustible materials away from LED/lamp & lens.
- Do not operate in close proximity to persons, combustible materials or substances affected by heat or drying.



WARNING

RISK OF FIRE, ELECTRIC SHOCK OR PERSONAL INJURY

- Allow LED/lamp & lens to cool before handling.
- Do not touch enclosure or light source.
- Do not exceed maximum wattage marked on luminaire label.
- Follow all manufacturer's warnings, recommendations, instructions and restrictions for driver type, burning position, mounting locations and replacement.



CAUTION

RISK OF PRODUCT DAMAGE

- Never connect luminaires and/or components under load with supply voltage turned on.
- Do not mount or support these luminaires in a manner that can cut the outer jacket or damage wire insulation.
- Do not restrict fixture ventilation. Allow for some volume of airspace around luminaire. Avoid covering luminaire with insulation, foam or other material that will prevent convection or conduction cooling.
- Do not exceed luminaire maximum ambient temperature.
- Do not modify the luminaire.
- Only use luminaire in its intended application and location.
- LED products are polarity sensitive. Ensure proper polarity before installation.
- Electrostatic Discharge (ESD) can damage LED. Personal grounding equipment must be worn during all installation and servicing of the luminaire.
- Do not touch individual electrical components as this can cause ESD, shorten LED life, or impact LED performance.
- Some components inside the luminaire may not be serviceable. In the unlikely event your luminaire may require service, stop using it immediately and contact the Customer Care Call Center at 800-555-0050.
- Always read the luminaire's complete installation instructions prior to installation for any additional luminaire specific warnings.
- In the case of HID or Fluorescent luminaires, regular re-lamping is required to keep luminaire operating within safe limits
- **Do not install damaged product.** Handling and installing damaged products can potentially increase the risks mentioned. In case of damage and/or missing parts upon arrival of the luminaire, please contact the Customer Care Call Center at 800-555-0050.
- These instructions do not purport to cover all details or variations in equipment nor to provide every possible contingency to meet in connection with installation, operation or maintenance. Should further information be desired, or should particular problems arise which are not covered sufficiently for the purchaser's or owner's purposes, this matter should be referred to the Customer Care Call Center at 800-555-0050. Please see luminaire specific Installation and Maintenance Instruction for additional warnings or any applicable FCC or regulatory statements. Failure to follow any of these instructions could void luminaire warranties.
- **Luminaire Maintenance**
- Regular luminaire maintenance programs are recommended.
- It is recommended to clean the outside of the luminaire and the refractor/lens.
- Frequency of cleaning will depend on ambient dirt level and minimum light output which is acceptable to user.
- If clean water is not sufficient for cleaning, use a neutral, synthetic, non-scratching and non-abrasive cleaning substance.
- Never use alkaline and/or acetous cleaning substances.
- Make sure that the cleaning substance is carefully removed by rinsing with lots of clean water.
- Signify recommends using a cleaning solution that has a PH between 5 and 8.
- Recycle: For information on how to recycle electronic products and components, please visit www.epa.gov.